

GENERAL DESCRIPTION

A special-applications fluorescent strip for installations where space is limited.

Designed for ceiling mount, wall mount or chain hanging.

Knockouts provided for a convenience outlet and a pull switch.

SPECIFICATIONS

Housing: Heavy-gauge cold rolled steel. Close-tolerance snap-fit construction. End plates with 7/8" knockouts for continuous mounting.

Cover: Secures with two #8 x 5/16" sheet metal screws.

Finish: White polyester polymer with a minimum of 82% reflectivity.

Mounting: Designed for surface, stem or chain hanging. Can be installed as individual units or in continuous rows.

(1) T8 LAMP

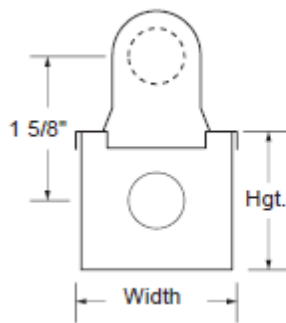

End View

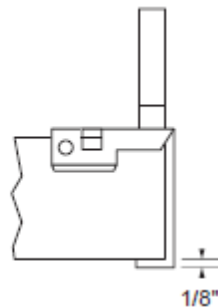

Side View

	Width	Height
Body Only:	1-5/8"	1-3/8"
W/End & Cover	1-13/16"	1-9/16"

(1 or 2) T5 LAMPS

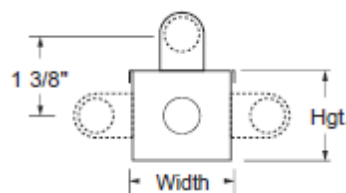

End View

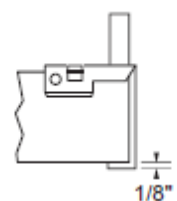

Side View

FIXTURE	Description
SN2-114	Strip Narrow, 22 in, 1 lamp, T5 14w 120v ballast
SN2-117	Strip Narrow, 2 ft, 1 lamp, T8 17w 120v ballast
SN2-214	Strip Narrow, 22 in, 2 lamp, T5 14w 120v ballast
SN3-121	Strip Narrow, 34 in, 1 lamp, T5 21w 120v ballast
SN3-125	Strip Narrow, 3 ft, 1 lamp, T8 25w 120v ballast
SN3-221	Strip Narrow, 34 in, 2 lamp, T5 21w 120v ballast
SN4-128	Strip Narrow, 48 in, 1 lamp, T5 28w 120v ballast
SN4-132	Strip Narrow, 4 ft, 1 lamp, T8 32w 120v ballast
SN4-228	Strip Narrow, 48 in, 2 lamp, T5 28w 120v ballast